

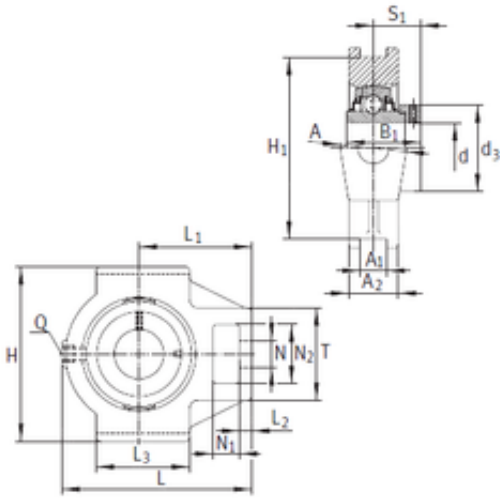

PCI BEARING EXPORTED LLC

INA RTUE75 Take-Up Ball Bearing

Bearing No. RTUE75



RTUE75 Bearing 2D drawings and 3D CAD models

Bore Diameter	75 mm
d	75 mm
S1	45,5 mm
Thread (Q)	Rp1/8
L2	20 mm
L3	120 mm
d3	100 mm
A	70 mm
A1	25 mm
B1	67 mm
H	166 mm
H1	151 mm
L	214 mm
L1	135 mm
N	41 mm
N1	35 mm
T	110 mm
A2	50 mm
N2	70 mm
Weight	6,44 Kg
Basic dynamic load rating (C)	62 kN
Category	Take Up Unit Bearings
Inventory	0.0
Manufacturer Name	SCHAEFFLER GROUP
Minimum Buy Quantity	N/A
Weight / Kilogram	8.306



PCI BEARING EXPORTED LLC

EAN	4012802068863
Product Group	M06110
Component Description	Take Up Bearing Only
Rolling Element	Ball Bearing
Housing Style	Unit Only
Mounting Method	Eccentric Collar
Compatible Take Up Frame	Not Specified
Adjustment Travel Length	0
Insert Part Number	GE75KRRB
Housing Material	Cast Iron
Other Features	Single Row Spherical Double Land Riding Rubber Contact Seal
Inch - Metric	Metric
Long Description	Take Up Bearing Only; 75MM Bore; 25MM Slot Width; 151MM Slot to Slot Distance; Ball Bearing; Unit Only; Eccentric Collar Mount; GE75KRRB Insert Part; Cast Iron Housing Material
Category	Take Up Units
UNSPSC	31171533
Harmonized Tariff Code	8483.20.40.40
Noun	Bearing
Keyword String	Take Up
Manufacturer URL	http://www.ina.com
Weight / LBS	15.545
Slot to Slot Distance	5.945 Inch 151 Millimeter
Slot Width	0.984 Inch 25 Millimeter
Bore	2.953 Inch 75 Millimeter